

IMPORTANT NOTE

This quick guide is a summary of the complete installation manual. The manual contains safety warnings and other explanations which must be taken into account. The installation manual can be downloaded by going to the "Downloads" section at the Erreka website:
<http://www.erreka.com/Automatismos/descargaDocumentos.aspx>

Elements of the complete installation

VULCAN

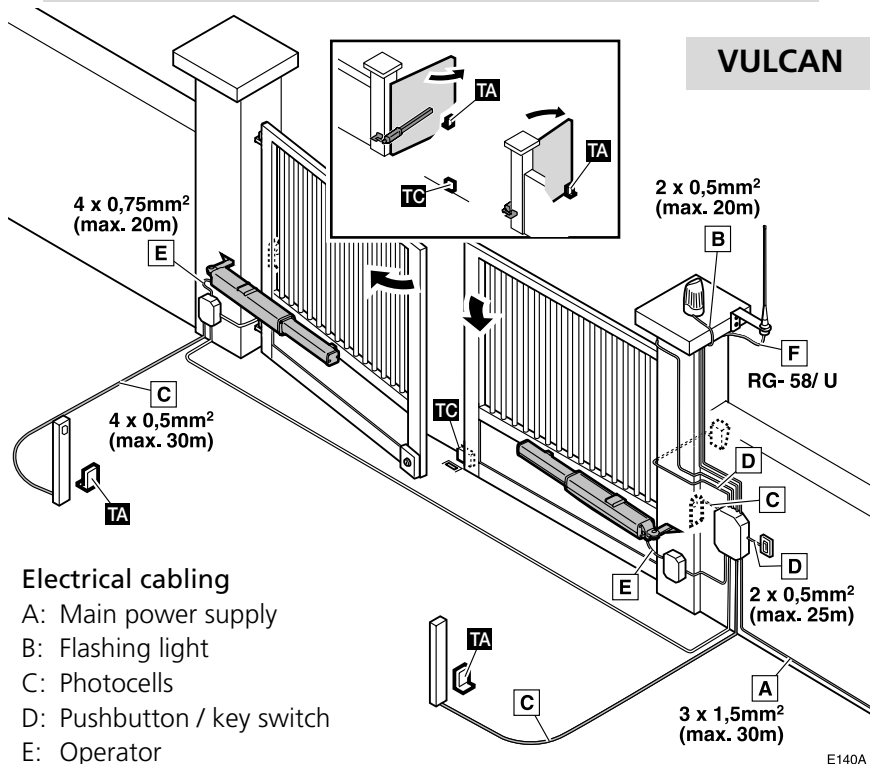

Electrical cabling

- A: Main power supply
- B: Flashing light
- C: Photocells
- D: Pushbutton / key switch
- E: Operator
- F: Antenna

VERY IMPORTANT: The **TC** closing stopper and the **TA** opening stoppers must be installed in all cases.

VULCAN S

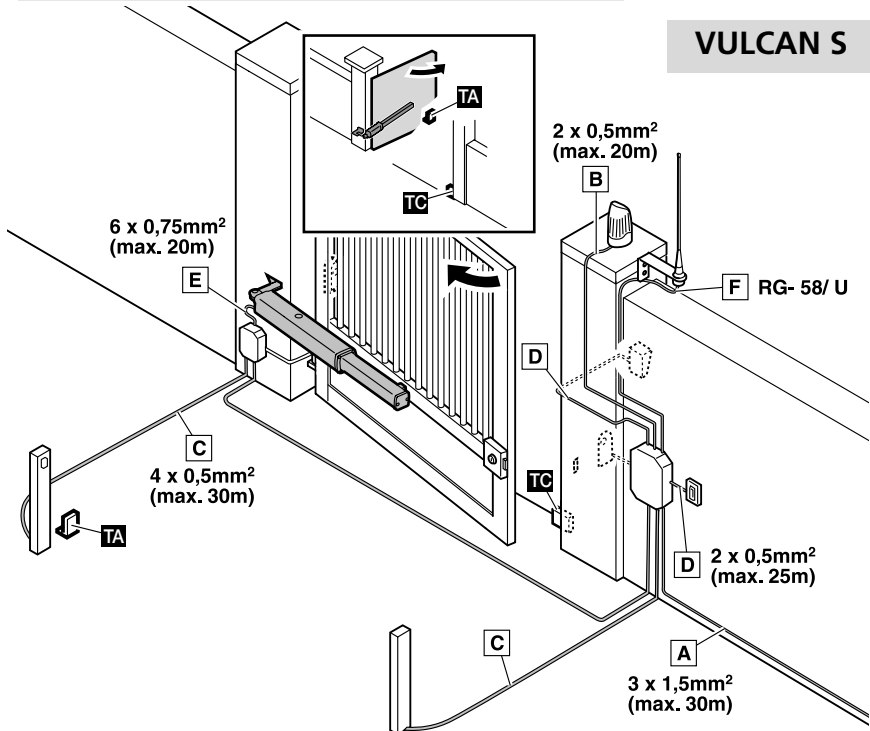

Unlocking

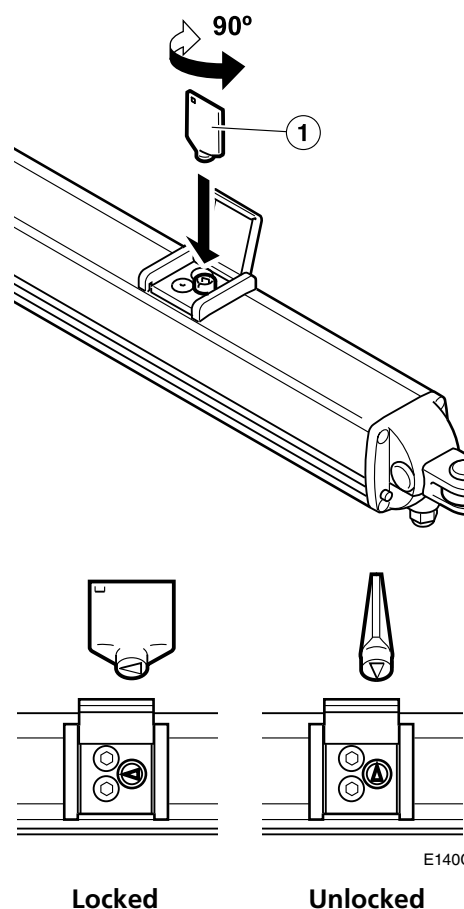

Unlocking for manual operation:

Turn the release key (1) in any direction until it is perpendicular to the operator spindle.

Motorised operation locking:

Turn the release key (1) in any direction until it is parallel to the operator spindle.

Assembly levels

Short operator, inward opening

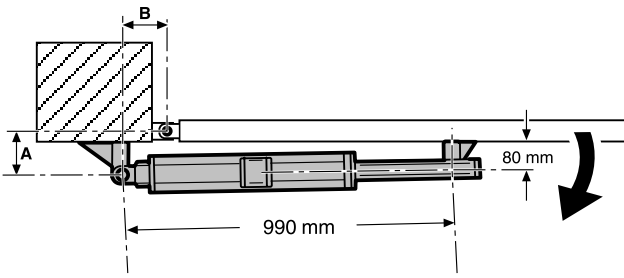

M140C

Opening angle	Level A	Level B
80°	155	130
85°	140	130
90°	140	120
90°	115	145
95°	125	125
100°	120	120
110°	105	120

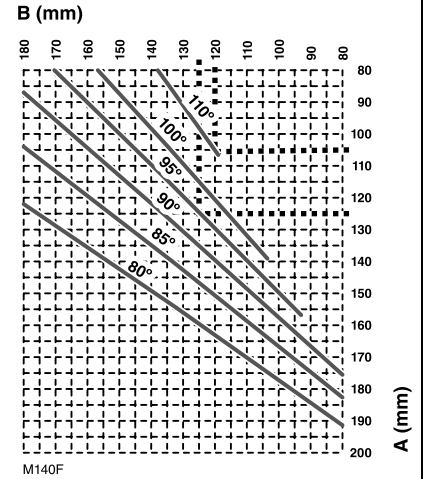

M140F

Short operator, outward opening

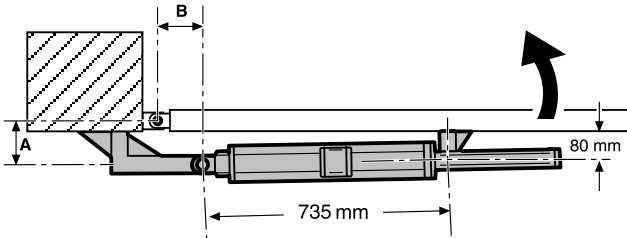

M140D

Opening angle	Level A	Level B
80°	150	135
85°	150	125
90°	100	155
90°	130	130
95°	120	130
100°	100	135
110°	95	125

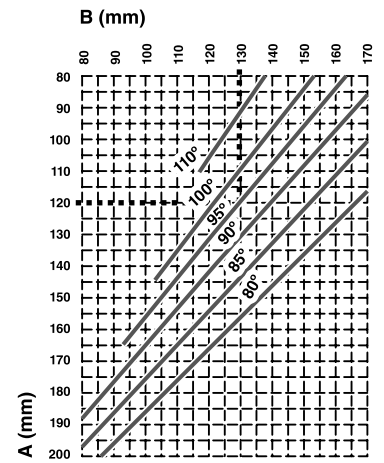

M140H

Long operator, inward opening

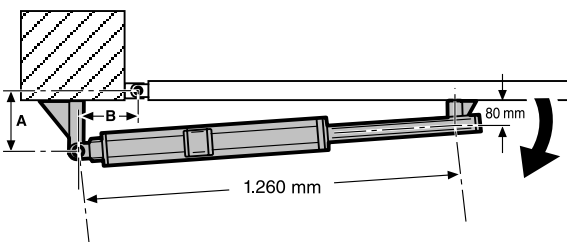

M140A

Opening angle	Level A	Level B
80°	250	180
85°	235	175
90°	200	195
90°	235	150
95°	220	155
100°	175	190
110°	190	155

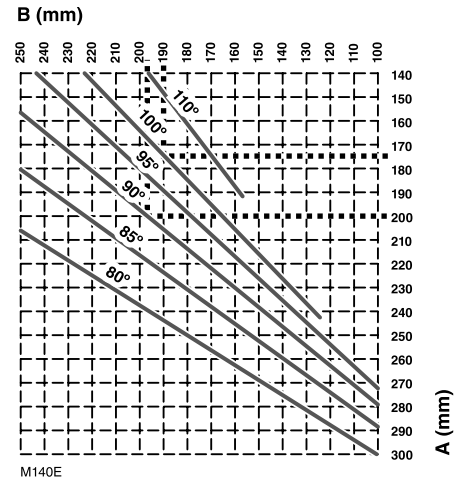

M140E

Long operator, outward opening

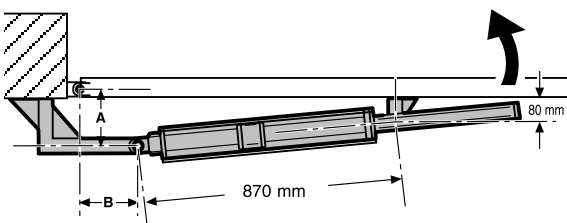

M140B

Opening angle	Level A	Level B
80°	200	235
85°	180	230
90°	165	225
90°	195	200
95°	160	215
100°	140	215
110°	140	195

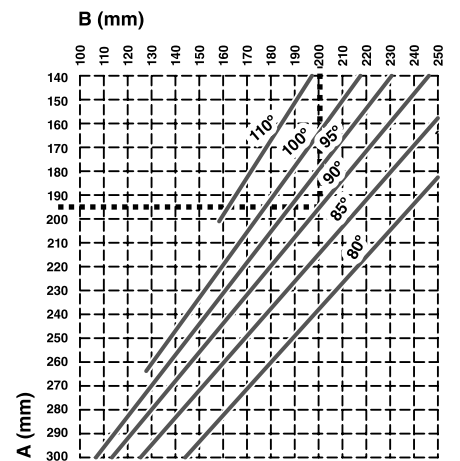

M140G

Levelling

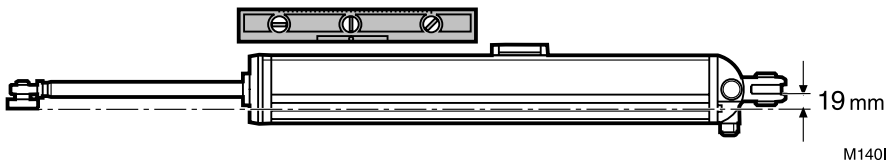

The operator must work horizontally: to do this, the supports must be positioned with a height difference of 19 mm.

Check horizontality with a spirit level.

Assembly

1 Mount the socket joint.

Before doing this, apply grease to the ball bearing joint and the piston rod.

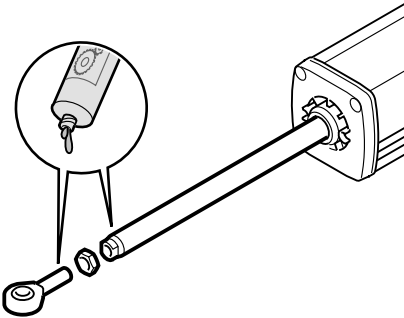

2 Mount the fork.

Horizontal pin: $\varnothing=10\text{mm}$, $L=57.2\text{mm}$

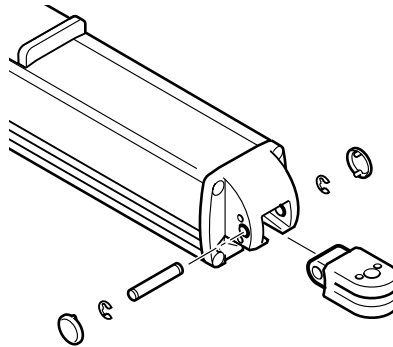

3 Mount the supports. Carry out the welding with the operator withdrawn to a distance, in order to prevent the spindle from being damaged by the welding.

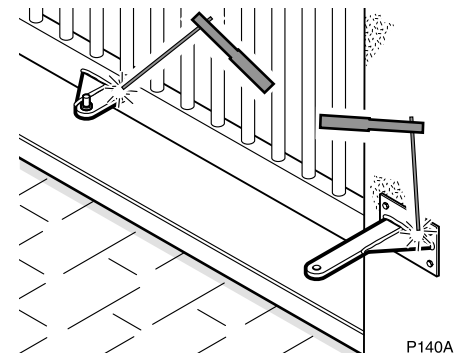

4 Mount the operator on the rear support.

Vertical pin: $\varnothing=12\text{mm}$, $L=37\text{mm}$

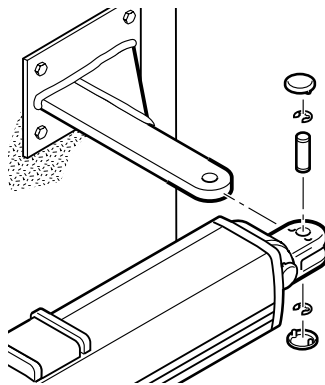

5 Mount the operator on the front support. Before doing this, apply grease to the ball bearing joint and the support pin.

Models with slowdown: adjust the socket joint in order to achieve the required slowdown distance.

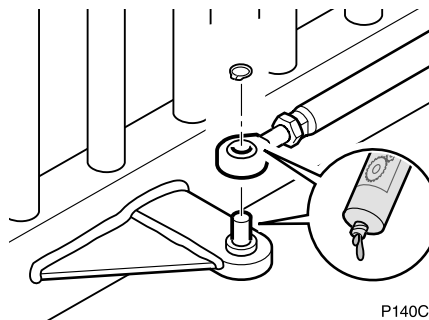

6 Mount the cover and the top.

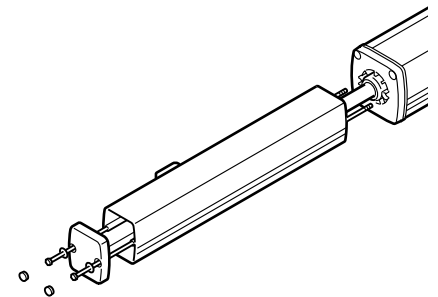

7 Loosen the discharge screw (P). If the operator has to be dismantled, retighten the screw in order to prevent the oil from leaking out.

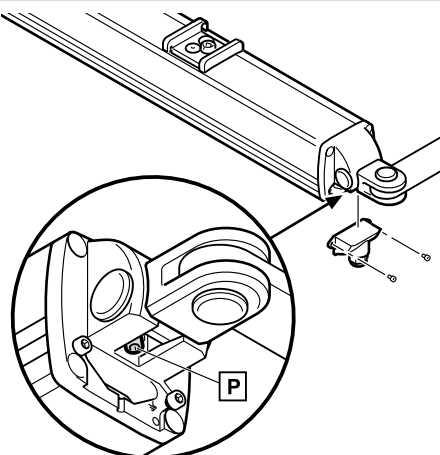

8 Mount the gland and introduce the cables.

VU models have 4 cables; VUS models have 6 cables.

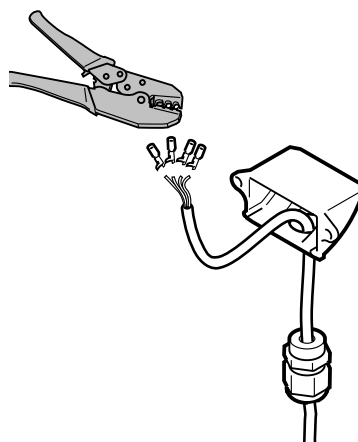

9 Complete the electrical connections as shown in the section below. Then position the cover (T) and tighten the gland.

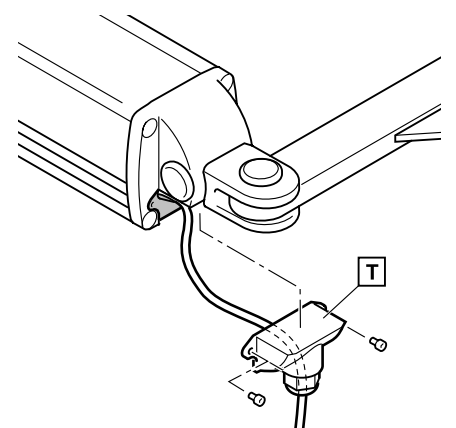

Electrical connections

VULCAN

VULCAN S

VIVO-M101(M)

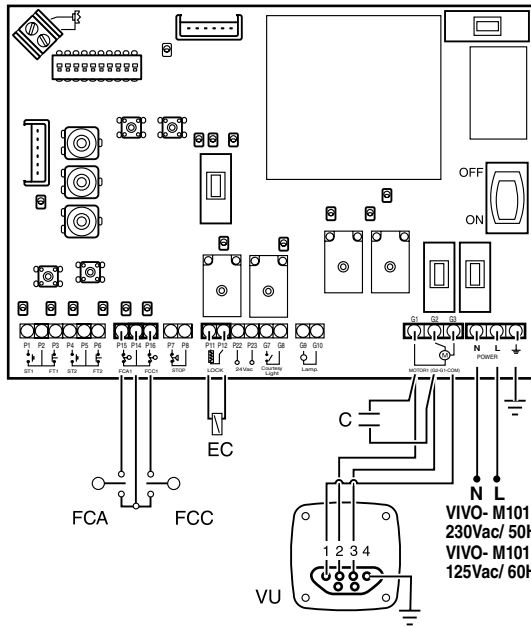

P140W

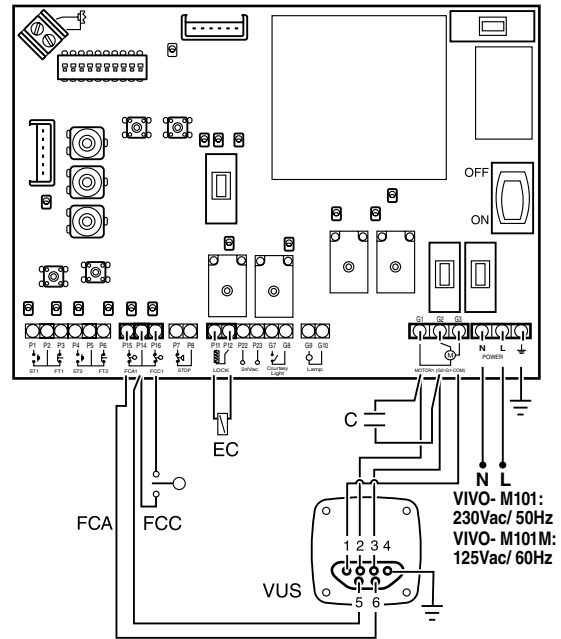

P140W1

- The VULCAN S operator has a safety device (cable connectors 5 and 6), making it necessary to use the VIVO-M101(M) switchboard. In order for this device to work properly, first connect cable connectors 5 and 6 of the operator to the FCA cable connectors of the VIVO-M101(M) switchboard and place DIP12 in ON.
- The VIVO-M101(M) or VIVO-M201(M) switchboard can be used for the VULCAN operator without internal safety device.

Adjusting the opening and closing pressures

⚠ The opening and closing pressures must be adjusted to fulfil standard EN12453:2000.

➤ Clockwork turning increases the pressure for both screws. Anti-clockwork turning reduces the pressure.

❗ Do not tighten the regulation screws (2) and (3) to the maximum, as this will result in damage.

CLOSING PRESSURE: yellow colour cap, screw (2).
The "Closing Pressure" is, more exactly, the pressure during the extension of the spindle. In inward opening facilities, it corresponds to the closing operation. In outward opening facilities, it corresponds to the opening operation.

OPENING PRESSURE: white colour cap, screw (3).
The "Opening Pressure" is, more exactly, the pressure during the retraction of the spindle. In inward opening facilities, it corresponds to the opening operation. In outward opening facilities, it corresponds to the closing operation.

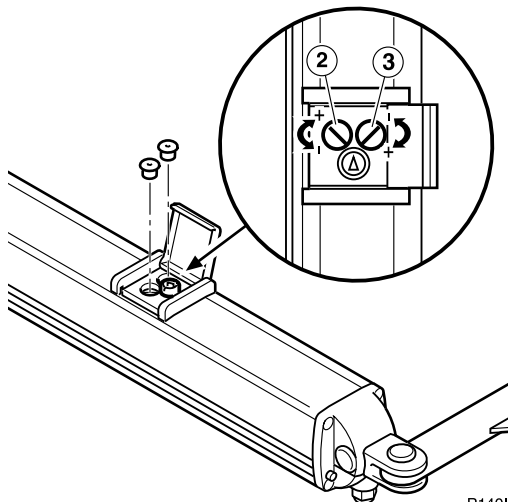

P140I

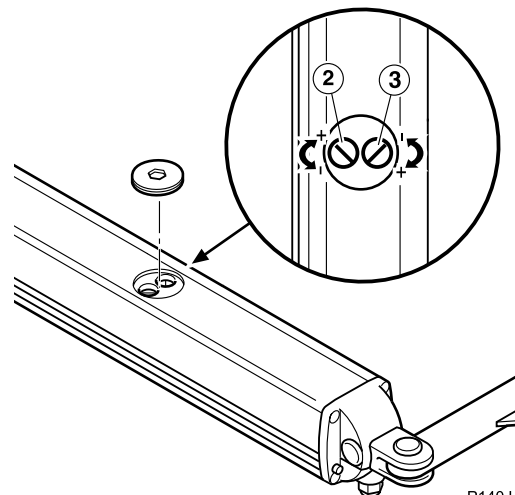

P140J