

### WARNING

This quick guide is a summary of the complete installation manual. The manual contains safety warnings and other explanations which must be taken into account. The installation manual can be downloaded by going to the "Downloads" section of Erreka website:  
<http://www.erreka.com/Automatismos/descargaDocumentos.aspx>

### Elements of the complete installation

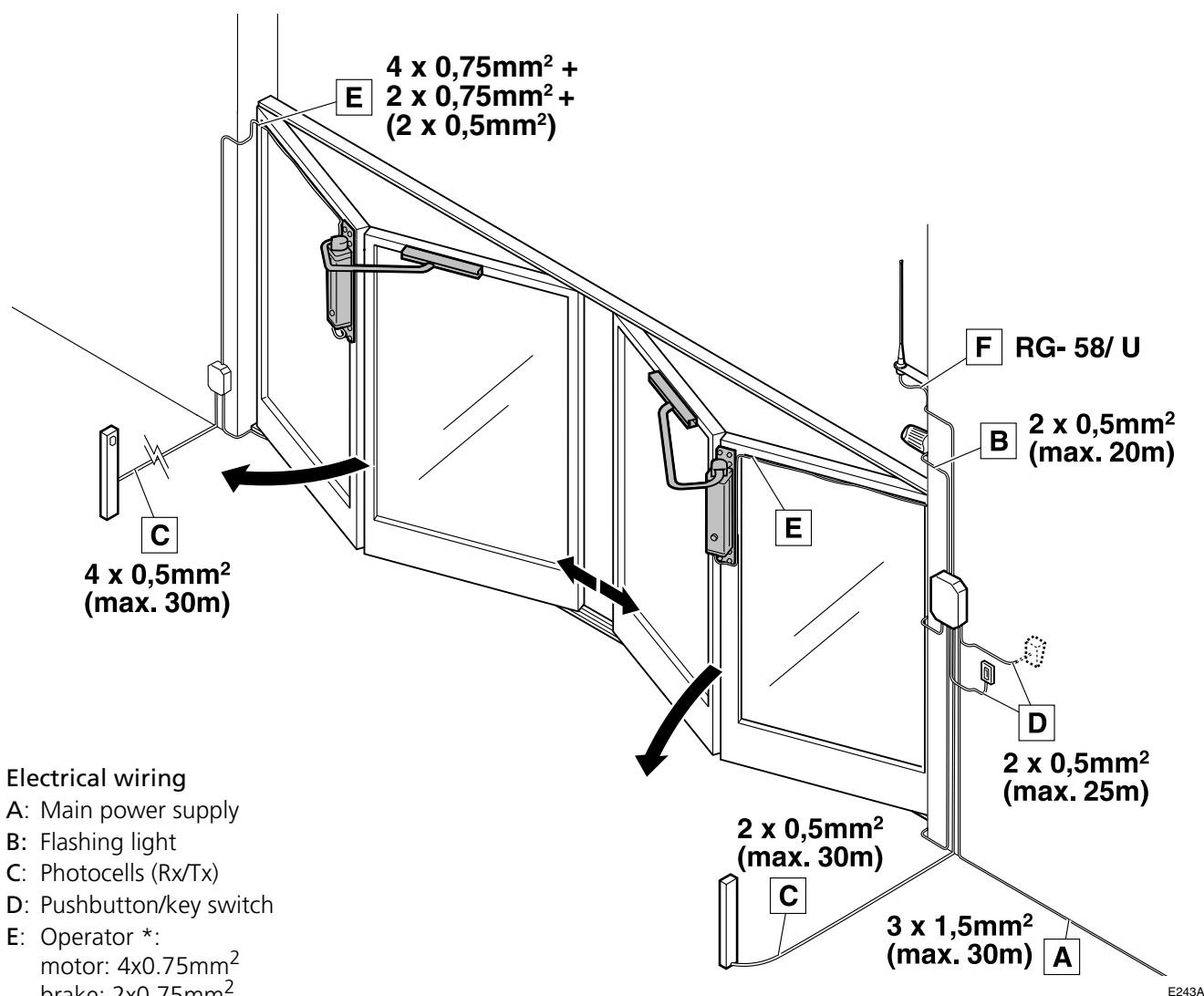

#### Electrical wiring

- A: Main power supply
- B: Flashing light
- C: Photocells (Rx/Tx)
- D: Pushbutton/key switch
- E: Operator \*:
  - motor: 4x0.75mm<sup>2</sup>
  - brake: 2x0.75mm<sup>2</sup>
  - encoder: shielded cable 2x0.5mm<sup>2</sup>
- F: Antenna

**\*NOTE:** the electrical installation of the operator can be done correctly and straightforwardly using the cable with AYC8 code, which ERREKA can supply by metre. This cable has the characteristics 4x1mm<sup>2</sup>+2x1mm<sup>2</sup>+ ((2x0.5mm<sup>2</sup>)) and was developed specifically for this use.

- ☞ Install the operator in the leaf closest to the wall.
- ☞ Install the opening stopper in the track and adjust it with the leaves completely open.

E243A

## Unlocking

### Unlocking

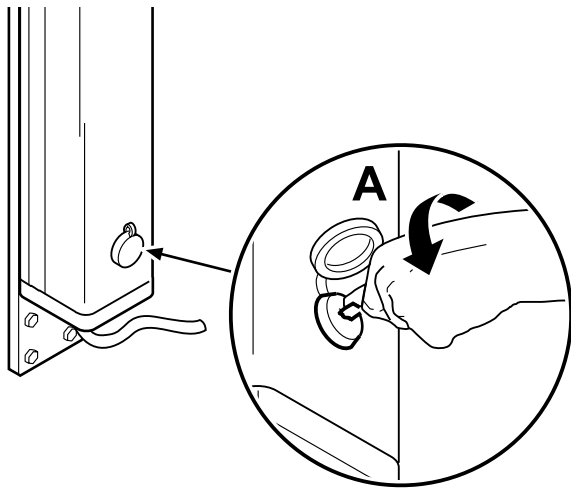

D243A

#### Unlocking for manual operation:

turn the release key (1) 90° anti-clockwise (A).

### Locking

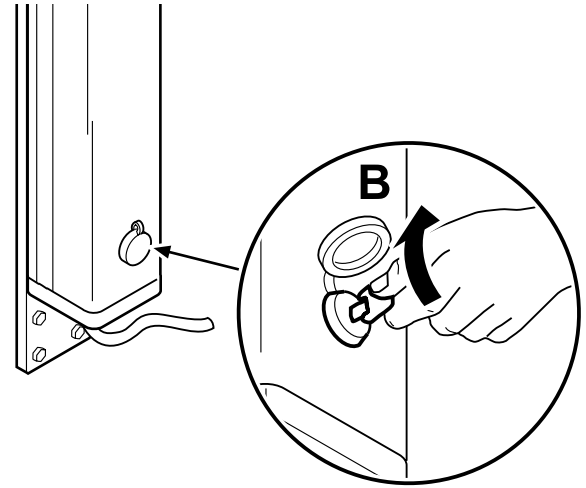

D243B

#### Motorised operation locking:

Turn the release key (1) 90° clockwise (B).

## Assembly levels

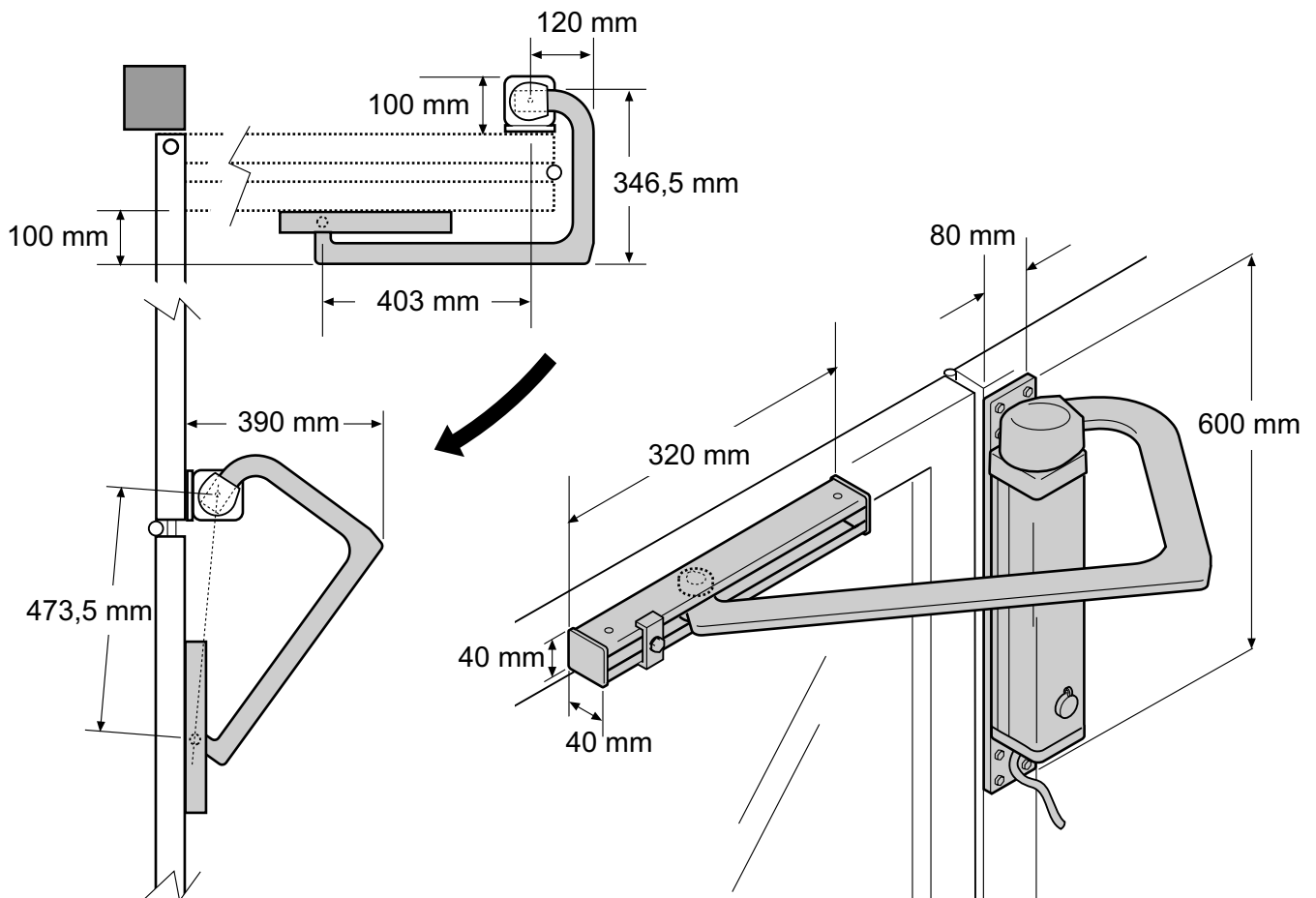

I243F

## Assembly

**1** Mount the operator on the support piece with the screws supplied.

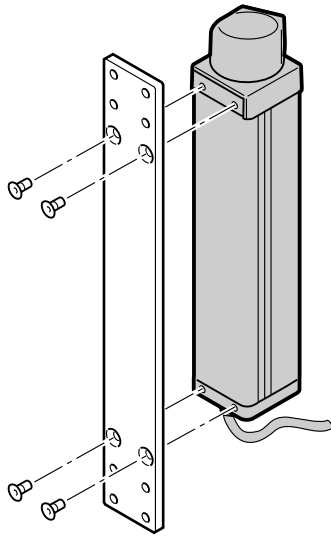

P243A

**2** Mount the unit on the door using the leaf closest to the wall, ensuring that it is perfectly upright.

☞ The drive wheel must be taken down in order to tighten the upper screws.

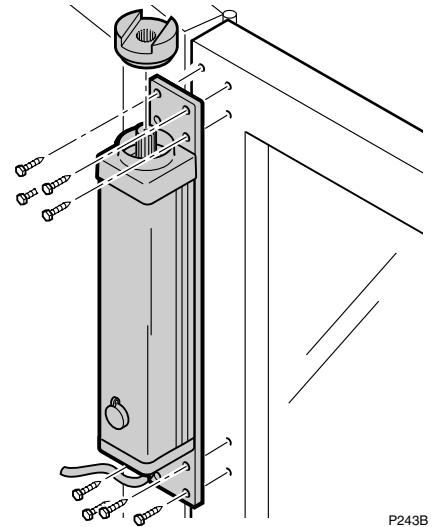

P243B

**3** Mount the operator anchor arm.

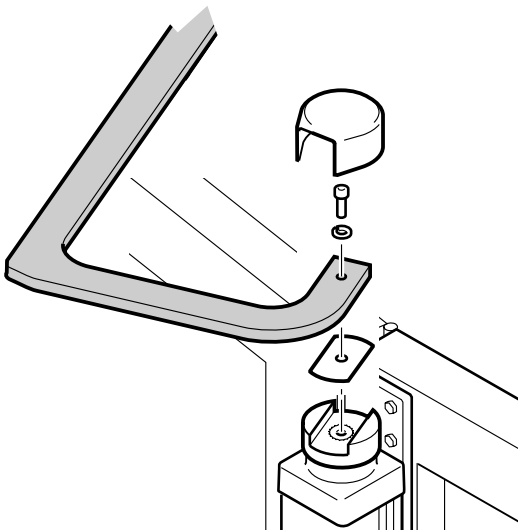

P243C

**4** Open the door completely and mark bearing position (A) on the door.

Then position the leaves at approximately 90° and mark bearing position (B) on the door.

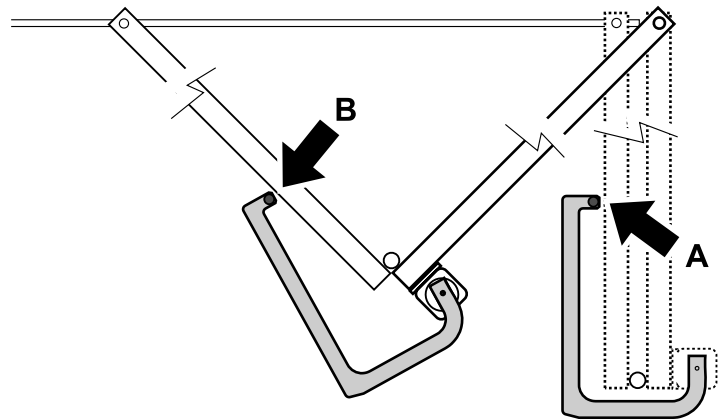

P243D

**5** Mount the track, ensuring it is aligned with regards to the two previous marks. Make sure it is perfectly horizontal.

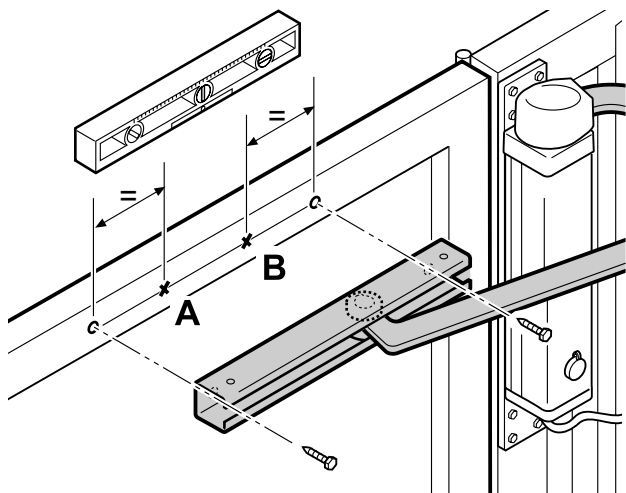

P243E

**6** Open the door completely and secure the opening stopper. Position the two side protection covers.

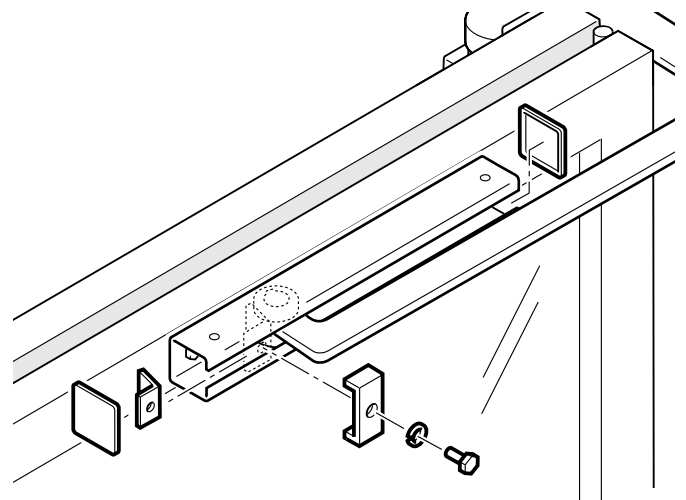

P243F

## Electrical connections with VIVO-M204(M) control board

☞ The VIVO-M204(M) operation panel is recommended for models both with encoder (DRS210F and DRS250F) and without encoder (DR210F and DR250F), since it is designed to operate the brakes of these operators.

⚠ **The basic connections to check the operation of the operators is shown below. Check the appropriate operation panel instructions manual for complete connections and programming.**

- F1 Protection fuse for the brakes
- COM Orange wire, FR1 and FR2 brakes
- L1 Purple wire, FR1 brake
- L2 Purple wire, FR2 brake
- DL1 FR1 indicator released
- DL2 FR2 indicator released

- ST1 open mini-pushbutton
- ST2 close mini-pushbutton

☞ Selecting  $\llcorner$  1 (or  $\llcorner$  2) and pressing ST1 (open) activates cable connectors G1-G3 of A1 (or G4-G6 of A2).

☞ Selecting  $\llcorner$  1 (or  $\llcorner$  2) and pressing ST2 (close) activates cable connectors G2-G3 of A1 (or G5-G6 of A2).

☞ The FR1 and FR2 brakes are released when voltage is applied to them.

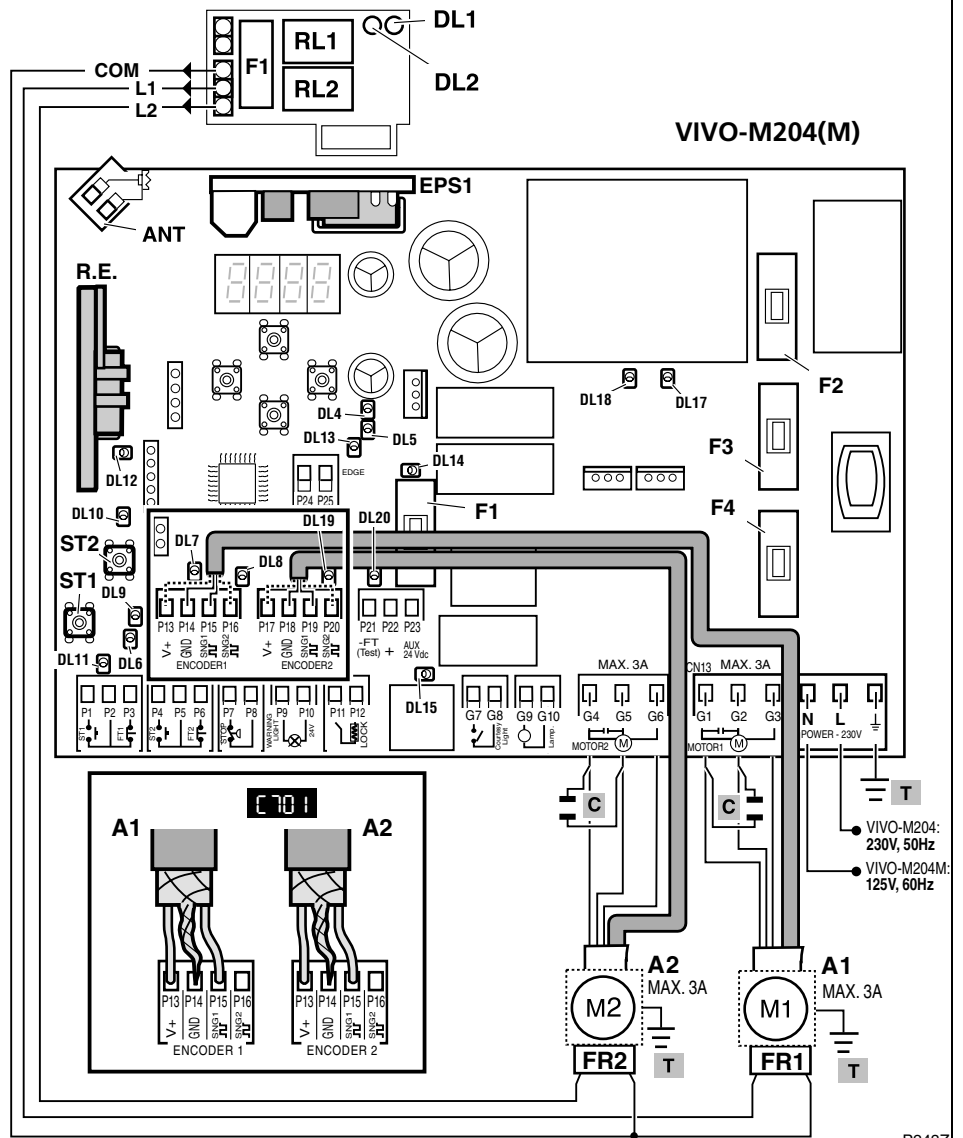

### Basic programming VIVO-M204(M):

- Select the number of operators using  $\llcorner$  0 ( $\llcorner$  00 1: one operator,  $\llcorner$  00 2: two operators).
- Select the turning directions using  $\llcorner$  1 (A1) and  $\llcorner$  2 (A2).
- Select the type of gate ( $\llcorner$  30 1 swing gate).
- Programme parameter  $\llcorner$  7 for operation with encoder ( $\llcorner$  70 1) or without encoder ( $\llcorner$  700).

### Encoder connections ( $\llcorner$ 70 1):

- V+: red cable
- GND: mesh
- SGN1: green or blue cable
- SGN2: do not connect

### Motor connections:

- G1/G4 open
- G2/G5 close
- G3/G6 common
- T earth connection

☞ When connecting a single operator, connect A1 (M1 and FR1).

### Wire colours G1/G4, G2/G5, G3/G6:

The colour of the G1/G4 and G2/G5 cables must be respected in order to correctly programme the turning directions, i.e., the colour of G1 must be the same as for G4 (and G2 the same as G5).