

# PUMA/ PUMA INVERTER ELECTROMECHANICAL MOTOR



## Sliding Gates

230 Vac motor with integrated control panel, for sliding gates up to 400 Kg with encoder and limit switches.

Inverter model available: Pushing force retained on slow down and allowing high duty cycle.



RESIDENTIAL

**ELECTRONIC SOFT START-SOFT STOP**

**SAFETY. OBSTACLE DETECTION**

**ACCURATE OPERATION WITH  
ENCODER**

**MAGNETIC LIMIT SWITCHES**

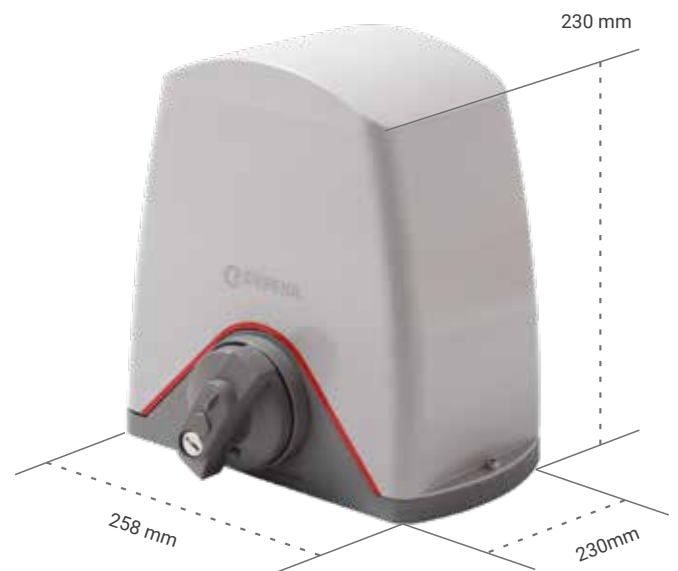

Practical  
unlocking  
system with  
personalized key



Control panel  
with INVERTER  
technology

# PUMA/ PUMA INVERTER ELECTROMECHANICAL MOTOR

## TECHNICAL CHARACTERISTICS

	PUS400EC	PUS400EIC
Power supply (Vac/Hz)	230/50	230/50-60
Power consumed (W)	280	230
Absorbed current (A)	1,2	1
Capacitor (µF)	8	-
Motor voltage (Vac)	230/50	
Torque (Nm)	12	
Speed (m/min)	10	
Lock	Yes	
Limit switches	Yes	
Encoder	Yes	
Pinion	M4-Z16	
Duty cycle	S3-25%	S3-50%
Protection level	IP44	
Operating temperature (°C)	-20 / +60	
Motor weight (kg)	9	
Packing dimensions (cm)	31,5x26x33,5	
Maximum weight of the leaf (kg)	400	

Assembly levels

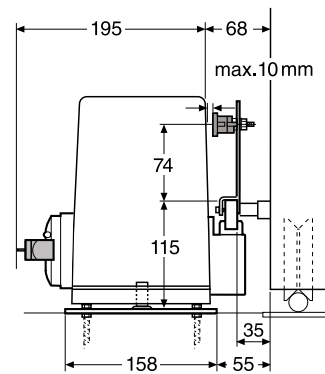

## RECOMMENDED KITS



	PUS400EC	PUS400EIC	IRRE2-250	IR02	FT06	LUMI
PUMA70	•		•	••	•	
PUMA130		•	•	••	•	
PUMA53	•		•	••	•	•
PUMA17		•	•	••	•	•

230 Vac

## INSTALLATION LAYOUT

