

IMPORTANT NOTE

This quick guide is a summary of the complete installation manual. The manual contains safety warnings and other explanations which must be taken into account. The installation manual can be downloaded by going to the "Downloads" section at the Erreka website: <http://www.erreka.com>

Elements of the complete installation

VULCAN

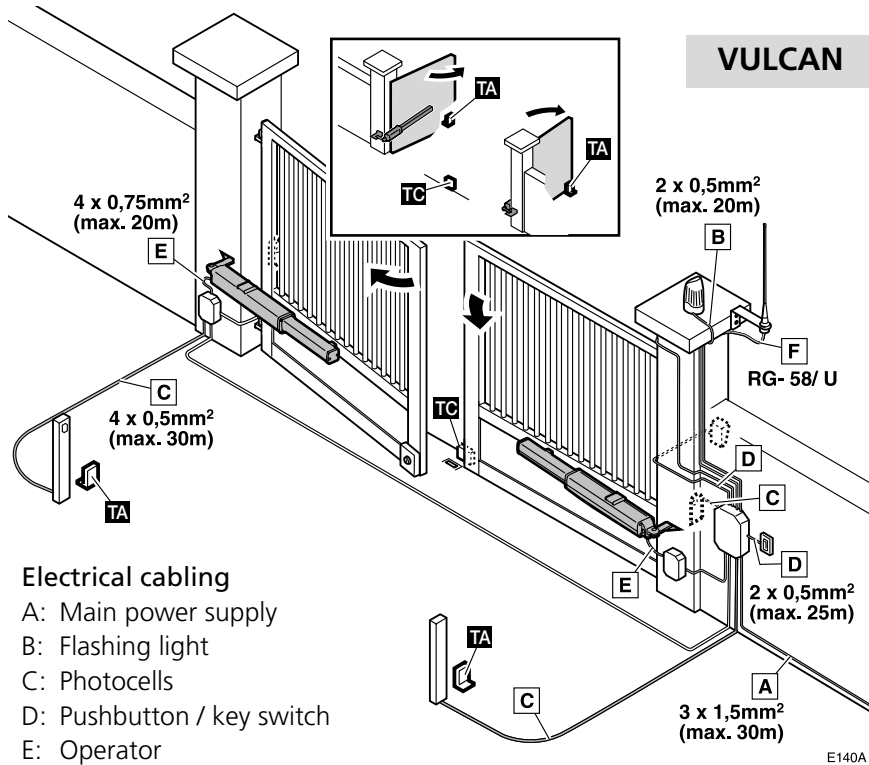

Electrical cabling

- A: Main power supply
- B: Flashing light
- C: Photocells
- D: Pushbutton / key switch
- E: Operator
- F: Antenna

VERY IMPORTANT: The **TC** closing stopper and the **TA** opening stoppers must be installed in all cases.

VULCAN S

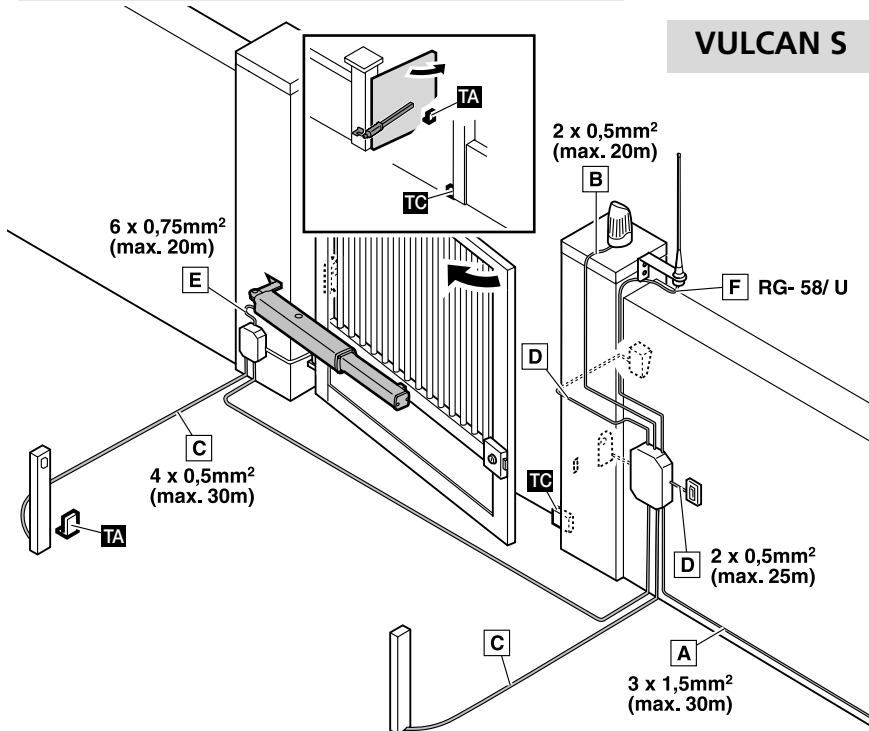

Unlocking

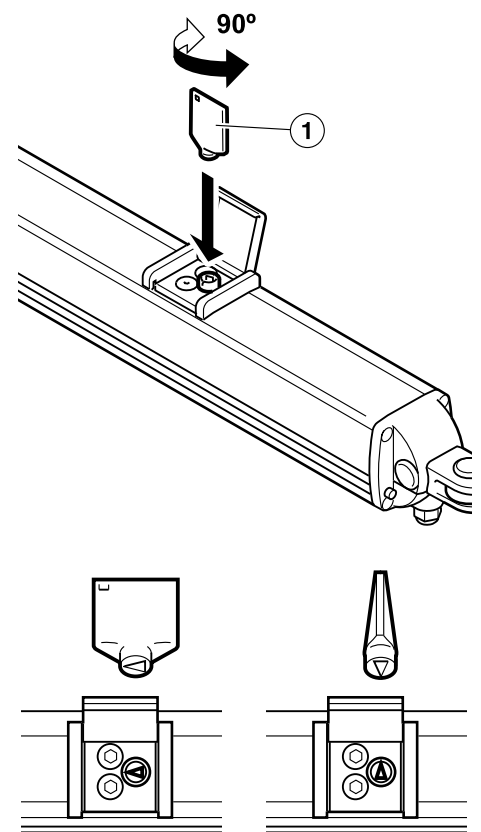

Unlocking for manual operation:

Turn the release key (1) in any direction until it is perpendicular to the operator spindle.

Motorised operation locking:

Turn the release key (1) in any direction until it is parallel to the operator spindle.

VERY IMPORTANT: using an electrolock with closing position microswitch is essential for VULCAN S.

Assembly levels

Short operator, inward opening

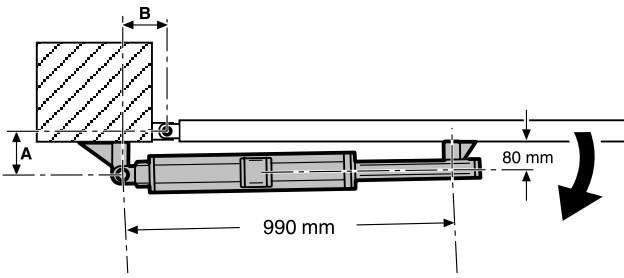

M140C

| Opening angle | Level A | Level B |
|---------------|---------|---------|
| 80° | 155 | 130 |
| 85° | 140 | 130 |
| 90° | 140 | 120 |
| 90° | 115 | 145 |
| 95° | 125 | 125 |
| 100° | 120 | 120 |
| 110° | 105 | 120 |

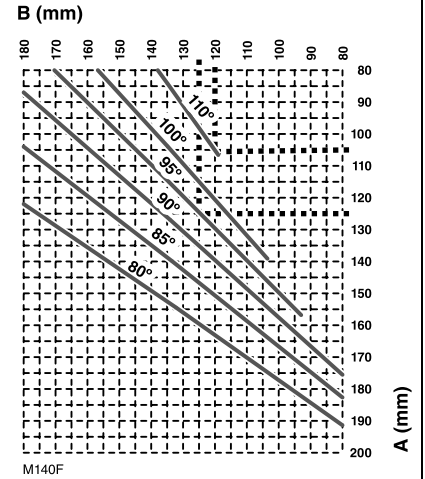

M140F

Short operator, outward opening

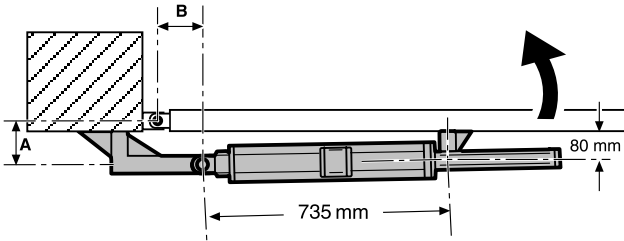

M140D

| Opening angle | Level A | Level B |
|---------------|---------|---------|
| 80° | 150 | 135 |
| 85° | 150 | 125 |
| 90° | 100 | 155 |
| 90° | 130 | 130 |
| 95° | 120 | 130 |
| 100° | 100 | 135 |
| 110° | 95 | 125 |

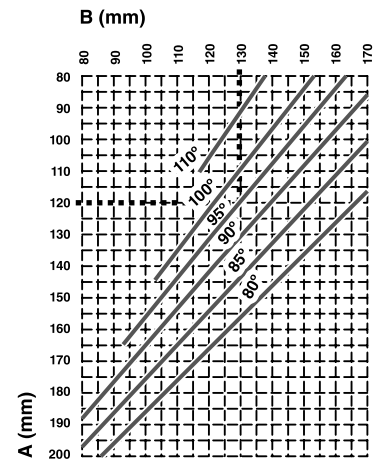

M140H

Long operator, inward opening

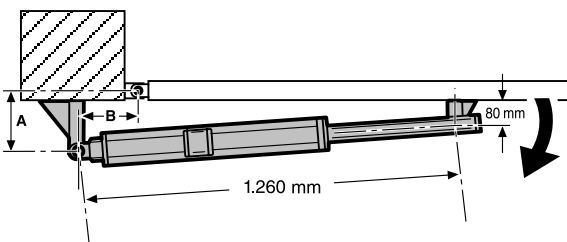

M140A

| Opening angle | Level A | Level B |
|---------------|---------|---------|
| 80° | 250 | 180 |
| 85° | 235 | 175 |
| 90° | 200 | 195 |
| 90° | 235 | 150 |
| 95° | 220 | 155 |
| 100° | 175 | 190 |
| 110° | 190 | 155 |

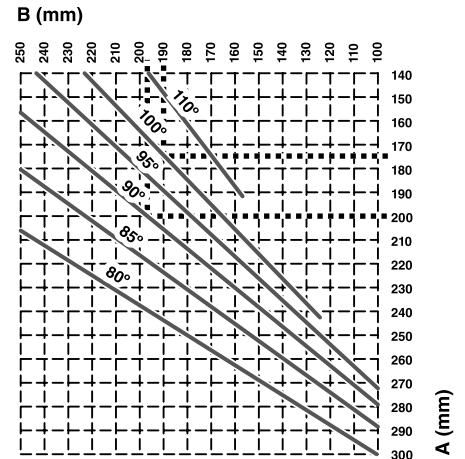

M140E

Long operator, outward opening

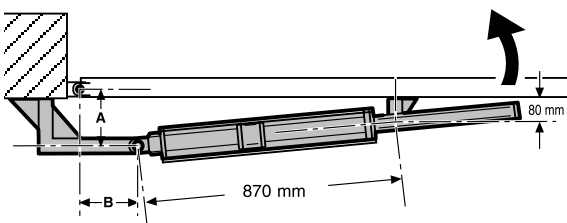

M140B

| Opening angle | Level A | Level B |
|---------------|---------|---------|
| 80° | 200 | 235 |
| 85° | 180 | 230 |
| 90° | 165 | 225 |
| 90° | 195 | 200 |
| 95° | 160 | 215 |
| 100° | 140 | 215 |
| 110° | 140 | 195 |

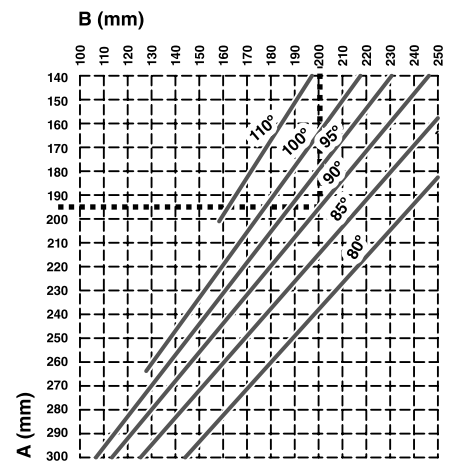

M140G

Levelling

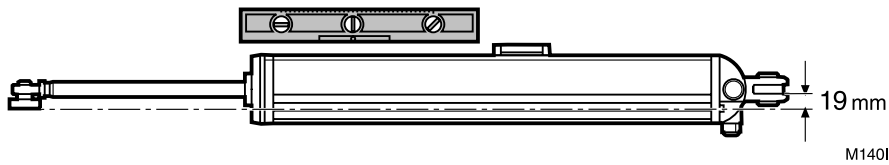

The operator must work horizontally: to do this, the supports must be positioned with a height difference of 19 mm.

Check horizontality with a spirit level.

Assembly

1 Mount the socket joint.

Before doing this, apply grease to the ball bearing joint and the piston rod.

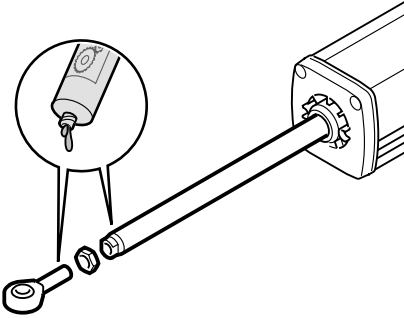

2 Mount the fork.

Horizontal pin: $\varnothing=10\text{mm}$, $L=57.2\text{mm}$

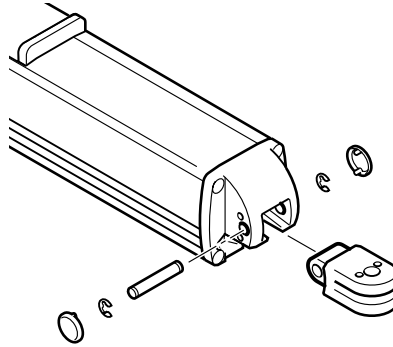

3 Mount the supports. Carry out the welding with the operator withdrawn to a distance, in order to prevent the spindle from being damaged by the welding.

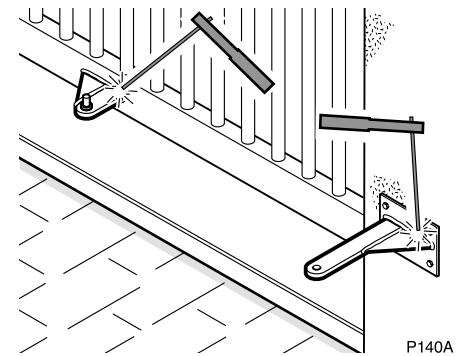

4 Mount the operator on the rear support.

Vertical pin: $\varnothing=12\text{mm}$, $L=37\text{mm}$

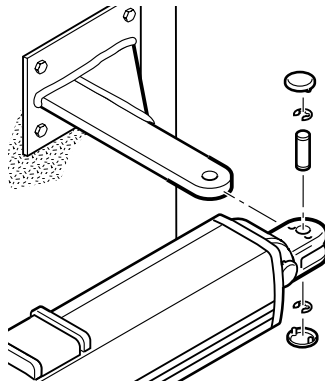

5 Mount the operator on the front support. Before doing this, apply grease to the ball bearing joint and the support pin.

Models with slowdown: adjust the socket joint in order to achieve the required slowdown distance.

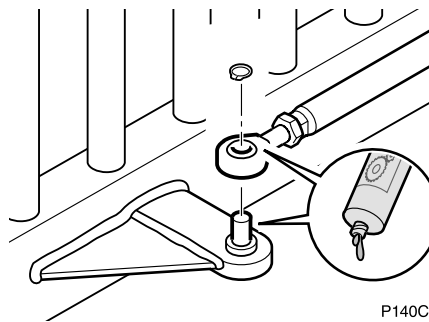

6 Mount the cover and the top.

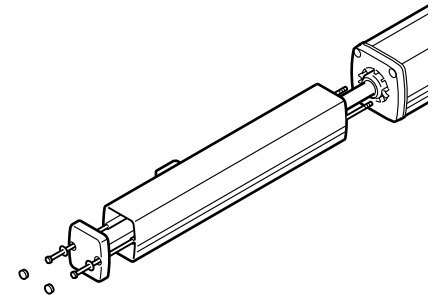

7 Loosen the discharge screw (P). If the operator has to be dismantled, retighten the screw in order to prevent the oil from leaking out.

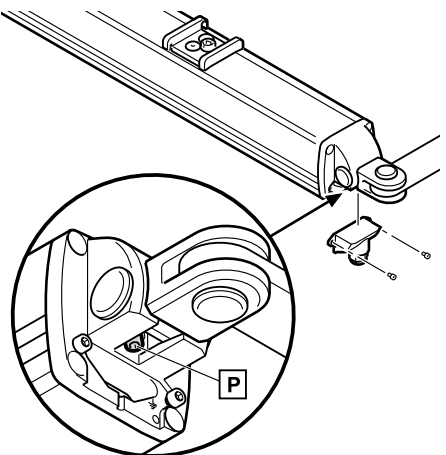

8 Mount the gland and introduce the cables.

VU models have 4 cables; VUS models have 6 cables.

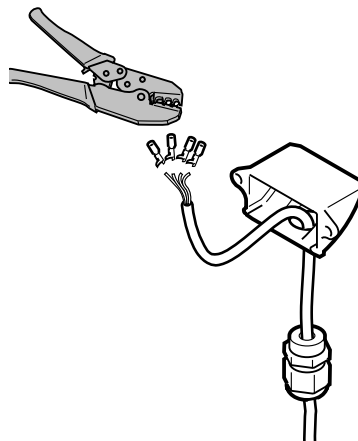

9 Complete the electrical connections as shown in the section below. Then position the cover (T) and tighten the gland.

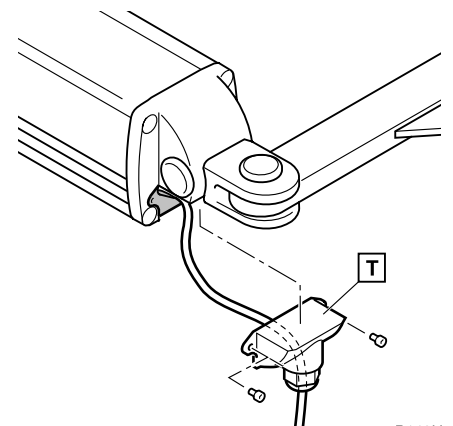

Electrical connections

VULCAN

VULCAN S

VIVO-M101(M)

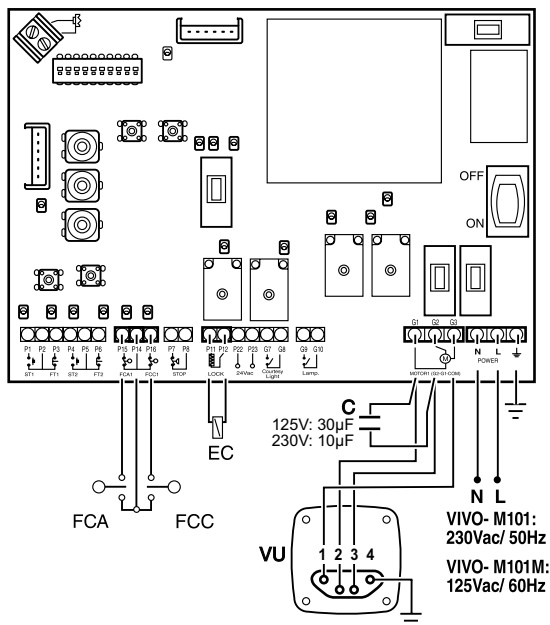

P140W

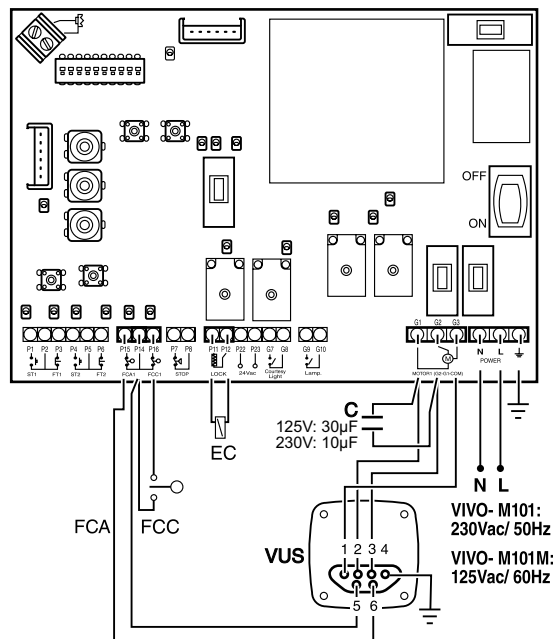

P140W1

- ✎ The VULCAN S operator has a safety device (cable connectors 5 and 6), making it necessary to use the VIVO-M101(M), VIVO-M203(M), VIVO-I103(M) or VIVO-I203(M) control board. Operator cable connectors 5 and 6 must be connected to the FCA cable connectors of the VIVO-M101(M), VIVO-M203(M), VIVO-I103(M) and VIVO-I203(M) control boards in order for this device to work. To start operation in the VIVO-M101(M), place DIP12 in ON position and programme $\square 705$ in the VIVO-M203(M), VIVO-I103(M) and VIVO-I203(M).
- ✎ The VIVO-M101(M), VIVO-M201(M), VIVO-M203(M), VIVO-I103(M) or VIVO-I203(M) control board can be used for the VULCAN operator without internal safety device.

Adjusting the opening and closing pressures

⚠ The opening and closing pressures must be adjusted to fulfil standard EN12453:2017.

- ✎ Clockwork turning increases the pressure for both screws. Anti-clockwork turning reduces the pressure.
- ❗ Do not tighten the regulation screws (2) and (3) to the maximum, as this will result in damage.

CLOSING PRESSURE: yellow colour cap, screw (2).
The "Closing Pressure" is, more exactly, the pressure during the extension of the spindle. In inward opening facilities, it corresponds to the closing operation. In outward opening facilities, it corresponds to the opening operation.

OPENING PRESSURE: white colour cap, screw (3).
The "Opening Pressure" is, more exactly, the pressure during the retraction of the spindle. In inward opening facilities, it corresponds to the opening operation. In outward opening facilities, it corresponds to the closing operation.

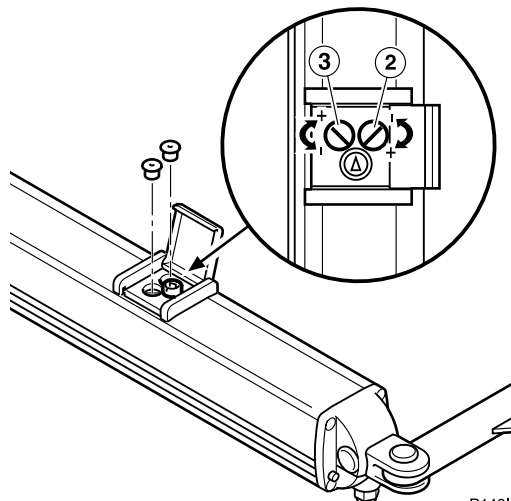

P140I

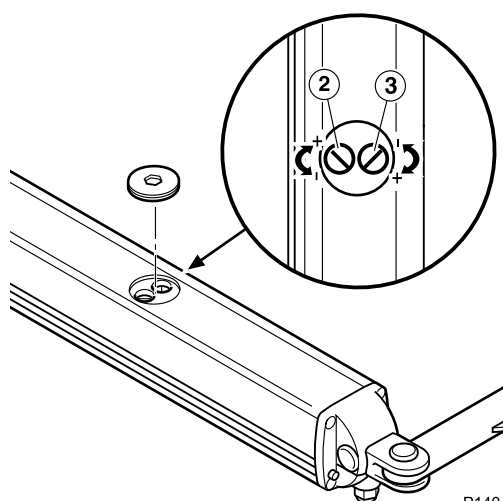

P140J